



---

**ZShield Product Line**



## **This is a call to arms to **Be The Shield****

**We are undoubtedly in the fight of our lives. The devastation of the coronavirus has touched every person, every business and every corner of the United States. It's easy to feel powerless against something so invisible, but if nothing else, we have our skills, our relationships, and the heart to take action for the greater good.**

**In March, we realized ZVerse was unique in the world: We have the processes, relationships and technology to accelerate mass production of personal protective equipment (PPE)—specifically face shields—very quickly. So, we played to our strengths, mobilizing our network of**

**world-class industrial engineers and suppliers across the U.S. and choosing injection molding over 3D printing to achieve the scalability required for meeting the demand for PPE. Today, we are producing hundreds of thousands of face shields a day, all designed, sourced and made in the USA.**

**By wearing one of our ZShields, you are helping to shield yourself and those around you, your neighbors, customers, nurses and doctors, grocery store clerks, teachers, hair stylists, restaurant servers and so many others. So, we are asking you to take up arms, and**

## **Be the Shield**



## Why We Made This

ZShield is designed to be a comfortable, wearable barrier that helps prevent the direct transfer of respiratory droplets from the user's mouth or nose onto persons, food or other objects. Our face shields are designed for clear verbal and nonverbal communication and comfort when masks or stationary sneeze guards are not practical. They are made in the USA, recyclable and easy to clean with soap and water.



**ZShield Flex, Wrap and Youth are innovative, neck-mounted face shields designed for everyday life. The optimal fit enables people to wear ZShields for prolonged periods of time without feeling hot or confining. The smart, ultra-lightweight design enables the plastic visor to flex up for active engagement and down for idle circumstances, allowing users to eat and take breaks without ever touching their face.**

**Importantly, ZShields allow communities to share smiles, and other important verbal and nonverbal communication, as we work together to stop the spread of COVID-19. This is the future of Personal Protective Equipment (PPE).**



Idle State



Active State

**Be the Shield**





**ZShield Flex, Wrap and Youth are being adopted by a wide range of businesses, including restaurants, pharmacies, salons and schools.**



**Be the Shield**





 ZSHIELD FLEX™

---

**Be the Shield**

 ZVERSE™





**ZShield Flex provides a practical PPE solution that fits comfortably around the neck for all-day wear. The anti-fog, waterproof shield allows for easy communication and breathing, while providing a barrier that prevents the direct transfer of respiratory droplets from the user's mouth or nose onto persons, food and other objects. Like all ZShields, the Flex is recyclable, reusable and made in the USA.**



**Be the Shield**





**Be the Shield**





# ZShield Flex Product Specifications

SKU# 300-022

GTIN: 850019658019

## Product Features:

- Optimal fit—can be comfortably worn for many hours
- Customer-friendly—allows visibility of facial expressions for verbal and non-verbal communication
- Interrupts bi-directional airflow for safer interactions
- Business-friendly—safer environment for employees and customers, while maintaining a positive experience
- Can easily adjust up for active engagement and down for idle circumstance
- Breakaway safety feature—allows for quick attaching and detaching from neck
- Ultra lightweight
- Minimal noticeability—forms to the user's neck and chest

## Assembly Instructions

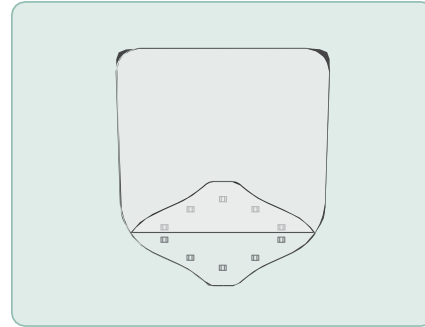

**01** Remove items from the box and place on a clean surface. Peel off protective cover/film on **both sides** of the visor starting from the bottom.

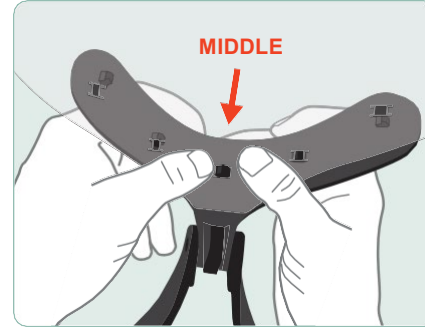

**02** Ensure neck mount is positioned upright in the idle setting. Align H-cuts in visor with prongs (middle). Attach the visor by snapping each prong to cut, working from the center to the outer prongs.

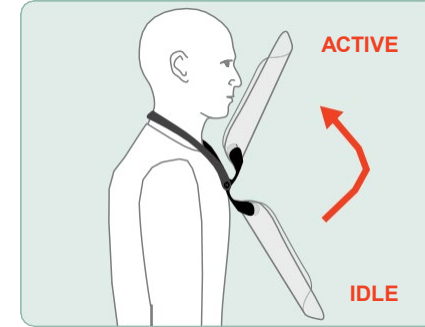

**03** Place around neck and adjust the device to the correct setting by shifting the shield up or down. The visor should cover the user's eyes, nose, and mouth for optimal protection.



**Visor Dimensions:**  
11.7" x 11.81" x .025"



**Shield Bracket Dimensions:**  
5.527" x 3.823 x 1.773"



**Neck Mount Dimensions:**  
8.64" x 5.70" x 1.78"

## Assembled Shield:



Active State



Idle State

## Materials Used:

Frame: Polypropylene (Black)  
Hypoallergenic

Visor: PETG (Optically Clear)

Note: Do not leave in extreme heat

## Customization:

Ask about customizing with your organizations primary color and logo!

## Cleaning Instructions:

Wash all components with soap and water

Frame—Dishwasher safe

Note: All components are shipped unsterilized

## Please Recycle



FRAME

# Be the Shield

The ZVerse Face Shield is not intended or approved as a replacement for other PPE, including but not limited to masks.





 ZSHIELD WRAP™

---

**Be the Shield**

 ZVERSE™



**ZShield Wrap follows a similar design to ZShield Flex, but with extended shield coverage around the face. ZShield Wrap meets the Center for Disease Control and Prevention's (CDC) guidance for face shields, which recommends the use of face shields that drop below the chin and wrap around the face.**



**Be the Shield**





**Be the Shield**





# ZShield Wrap Product Specifications

SKU# 302-023

GTIN: 850019658385

## Product Features:

- Larger wrap around visor provides additional facial coverage
- Optimal fit—can be comfortably worn for many hours
- Customer-friendly—allows visibility of facial expressions for verbal and non-verbal communication
- Redirects bi-directional airflow
- Can easily adjust up for active engagement and down for idle circumstance
- Breakaway safety feature—allows for quick attaching and detaching from neck
- Ultra lightweight
- Minimal noticeability—forms to the user's neck and chest
- Meets Centers for Disease Control and Prevention (CDC) guidance for face shields

## Assembly Instructions

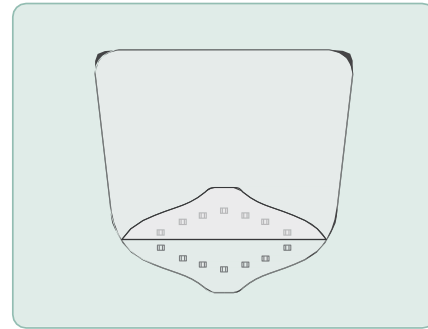

**01** Remove items from the box and place on a clean surface. Peel off protective cover/film on **both sides** of the visor starting from the bottom.

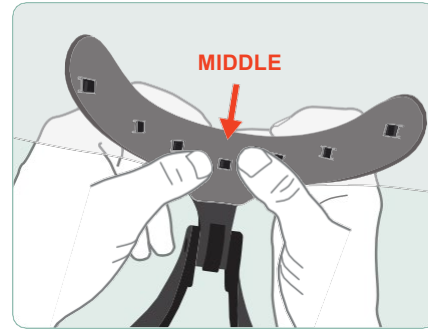

**02** Ensure neck mount is positioned upright in the idle setting. Align H-cuts in visor with prongs (middle). Attach the visor by snapping each prong to cut, working from the center to the outer prongs.

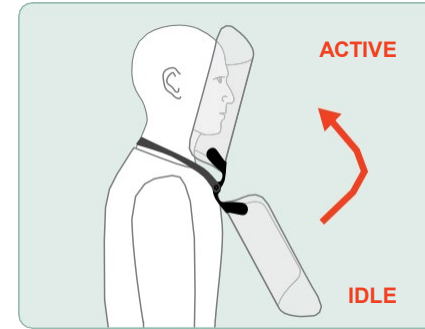

**03** Place around neck and adjust the device to the correct setting by shifting the shield up or down. The visor should cover the user's eyes, nose, and mouth for optimal protection.



**Visor Dimensions:**  
11.7" x 12.8" x .02"



**Shield Bracket Dimensions:**  
5.34" x 2.46" x 3.9"



**Neck Mount Dimensions:**  
8.64" x 5.70" x 1.78"

## Assembled Shield:



Active State



Idle State

## Materials Used:

Frame: Polypropylene (Black)  
Hypoallergenic

Visor: PETG (Optically Clear)

Note: Do not leave in extreme heat

## Customization:

Ask about customizing with your organizations primary color and logo!

## Cleaning Instructions:

Wash all components with soap and water

Frame—Dishwasher safe

Note: All components are shipped unsterilized

## Please Recycle



FRAME

# Be the Shield

The ZVerse Face Shield is not intended or approved as a replacement for other PPE, including but not limited to masks.





ZSHIELD YOUTH™



---

**Be the Shield**





**ZShield Youth offers children a comfortable, lightweight option for PPE that is practical for all-day wear. This shield is designed to be a smaller version of our ZShield Wrap product, ideal for children ages 5 to 11. The collar is CAGE approved and designed with breakaway technology, deterring the risk of choking.**



**Be the Shield**





**Be the Shield**

 **ZSHIELD YOUTH™**



# ZShield Youth Product Specifications

SKU# 300-024

GTIN: 85001965658

## Product Features:

- Optimal fit—can be comfortably worn for many hours
- Allows visibility for facial expressions to maintain a positive learning environment
- Redirects bi-directional airflow
- Can easily adjust up for active engagement and down for idle circumstance
- Breakaway safety feature—allows for quick attaching and detaching from neck
- Ultra lightweight
- Minimal noticeability—forms to the user's neck and chest
- Meets Consumer Product Safety Commission (CPSC) Safety Requirements

## Assembly Instructions

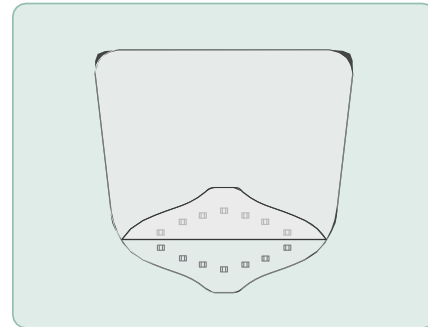

**01** Remove items from the box and place on a clean surface. Peel off protective cover/film on **both sides** of the visor starting from the bottom.

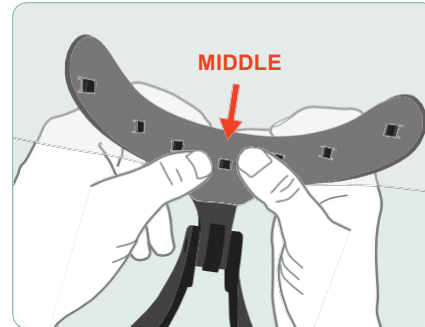

**02** Ensure neck mount is positioned upright in the idle setting. Align H-cuts in visor with prongs (middle). Attach the visor by snapping each prong to cut, working from the center to the outer prongs.

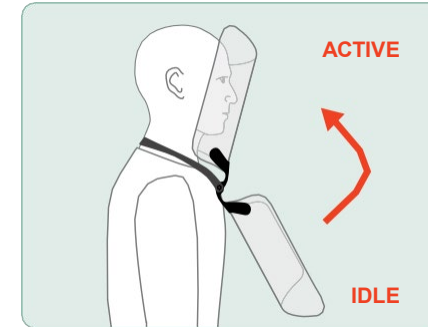

**03** Place around neck and adjust the device to the correct setting by shifting the shield up or down. The visor should cover the user's eyes, nose, and mouth for optimal protection.



**Visor Dimensions:**  
10.26" x 9.22" x .02"



**Shield Bracket Dimensions:**  
5.34" x 2.46" x 3.9"



**Neck Mount Dimensions:**  
4.18" x 4.2" x 1.4"

## Assembled Shield:



Active State



Idle State

## Materials Used:

Frame: Polypropylene (Black)  
Hypoallergenic

Visor: PETG (Optically Clear)

Note: Do not leave in extreme heat

## Customization:

Ask about customizing with your organizations primary color and logo!

## Cleaning Instructions:

Wash all components with soap and water

Frame—Dishwasher safe

Note: All components are shipped unsterilized

## Please Recycle



FRAME

# Be the Shield

The ZVerse Face Shield is not intended or approved as a replacement for other PPE, including but not limited to masks.



 ZSHIELD HEALTH™



**Be the Shield**

 ZVERSE™



**ZShield Health is designed to shield frontline workers in high-risk COVID-19 environments. ZShield Health is most effective when worn with a mask. Our face shields offer the following benefits for the healthcare community:**

- **Prevents respiratory droplets from entering the nose, mouth and eyes**
- **Fits without gaps at the forehead**
- **Reaches to the ears**
- **Extends below the chin**
- **Features waterproof, clear, anti-fog plastic material that is reusable and recyclable**



**Be the Shield**





**Be the Shield**





# ZShield Health Product Specifications

MADE IN THE USA

SKU# 200-037

Each set includes one each of these component parts:

## Headset



### Dimensions

X - 8.16" Y - 7.78" Z - 0.47"

### Materials

Profax 6323 (PP Homopolymer)  
Profax 6523 (PP Homopolymer)  
Profax PD702 (PP Homopolymer)

**Usage** Multi-Use  
**Sterilization** NON-STERILE

### Sterilization/Cleaning Instructions

The autoclave must reach and maintain a temperature of 121° C for at least 30 minutes by using saturated steam under at least 15 psi of pressure (note: applies to headsets only).

## Visor

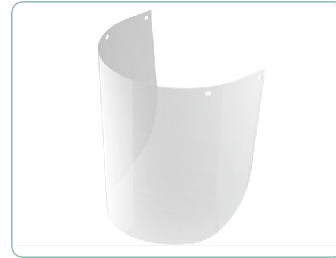

### Dimensions

8.75" L

**Materials** Polycarbonate  
PETG  
APET

**Usage** Multi-Use

**Sterilization** NON-STERILE

### Sterilization/Cleaning Instructions

- Wipe down with soap and warm water
- UV Sterilization

## Application Band

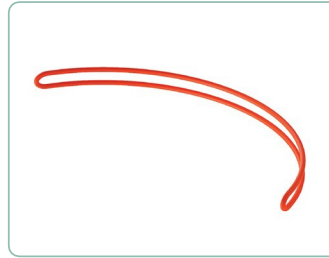

### Dimensions

Standard Elastic Band

**Materials** Organic Rubber

**Usage** Single-Use

**Sterilization** NON-STERILE

### Safety Tips

- Each headset should be cleaned between uses
- Parts should not be shared between persons without submitting for sterilization
- Always practice good hygiene

### Flex Fit

The headset is designed for an adjustable fit. If you gently bend the arms outward, you'll be able to get a more comfortable fit for larger head sizes.

### Please Recycle



## Assembly Instructions

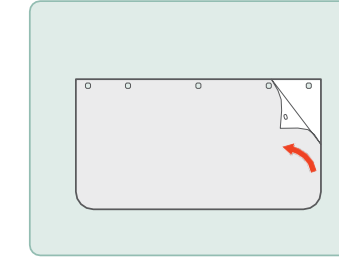

1. Remove items from box and place on a clean surface. Peel off protective cover from visor.

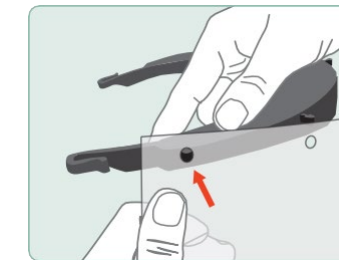

2. Ensure headset is positioned correctly with "top side" facing up. Align holes in visor with pins in headset (left to right). Attach visor to headset by snap-fitting each prong to hole.

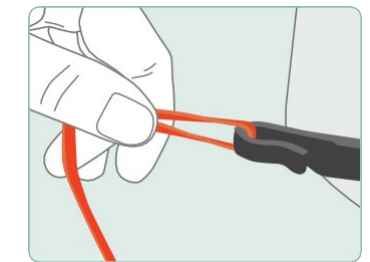

3. Loop application band through hooks in headset.

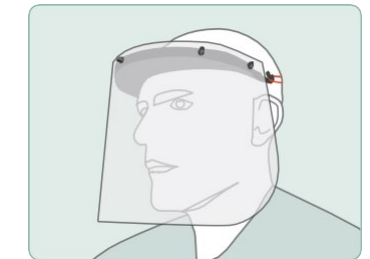

4. Apply protective face shield to head and secure in place with application band.

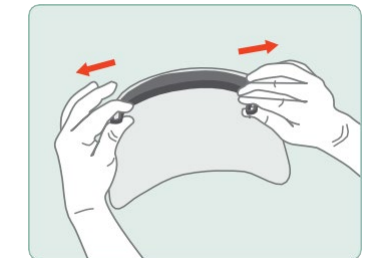

5. For larger head sizes, gently bend the arms of the headset outward for a more comfortable fit.

# Be the Shield

Personal Protective Equipment EUA

On the basis of this determination, the Secretary of Health & Human Services declared that circumstances exist justifying the authorization of emergency use of personal respiratory protective devices during the COVID-19 outbreak pursuant to section 564 of the FD&C Act, subject to the terms of any authorization issued under that section.

If you have any questions, please email: [CDRH-NonDiagnosticEUA-Templates@fda.hhs.gov](mailto:CDRH-NonDiagnosticEUA-Templates@fda.hhs.gov)





**Cedric Harrison**

Zverse Sales

[cedric.harrison@zverse.com](mailto:cedric.harrison@zverse.com)

803-218-8588

**Be the Shield**





**Thank You.**



**Be the Shield**

For more information:  
[covidsupport@zverse.com](mailto:covidsupport@zverse.com)

**MADE IN THE USA**

